



HINO 700 SERIES

SR1EKR6 | 6 X 2 PRIME MOVER
GCW 66,000KG



HINO MOTORS SALES (MALAYSIA) SDN BHD (187863-U)

Selangor: Lot PT. 24, Jalan 223, Section 51A, 46100 Petaling Jaya, Selangor Darul Ehsan, Malaysia. Tel: (603) 7957 5199 (12 talian) Faks: (603) 7954 3276 / 7957 2235

Sarawak: Lot 3477, Block 226 KNLD, Off Jalan Datuk Amar Kalong Ningkan, 93250 Kuching, Sarawak, Malaysia. Tel: (082) 451 611 (5 talian) Faks: (082) 451 993

Sabah: Mile 4½, Tuaran Road, Lot No. 353, Taman Cempaka, Likas, 86450 Kota Kinabalu, Sabah, Malaysia. Tel: (088) 393 663 Faks: (088) 424 223

www.hino.com.my

PERFORMANCE

MT 6 x 2
PRIME
MOVER



NEW
AMT 6 x 2
PRIME MOVER

EURO 3

ENGINE MODEL
E13C-TM

DISPLACEMENT :

12,913cc, 6-cylinder in-line,
Turbo-Charged Intercooler,
Commonrail

ENGINE OUTPUT :

309kW (420PS) / 1,800rpm

E/G TORQUE :

1,903Nm (194kgfm) / 1,100rpm

AUTO CRUISE

ENGINE RETARDER

SR1EKR

SAFETY



LIFT DOWN SWITCH

Manual switch allows drivers to have the flexibility to lower the 3rd axle when required.



LIFTABLE 3RD AXLE

Improved operation flexibility with lower tire wear and tear, better fuel efficiency while maintaining high loading capacity with the liftable axle.

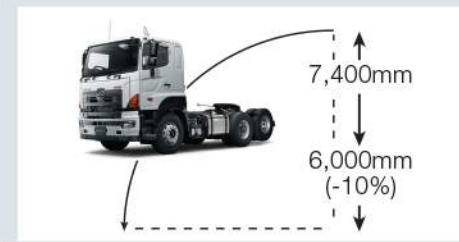

BETTER MANEUVERABILITY (BETTER TURNING RADIUS)

In narrow situations, small turning radius is preferable. By lifting of the last axle, our turning radius is improved by almost 10% making it easier to maneuver in tight spots.

<Turning radius (on tire)>

- 3 axle operation (Lift down) = 7,400mm
- 2 axle operation (Lift up) = 6,000mm

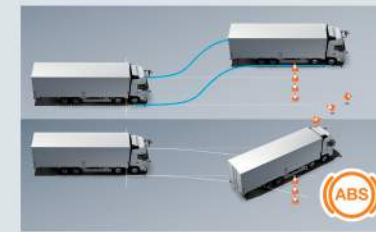

ANTILOCK BRAKING SYSTEM (ABS)

ABS helps the driver maintain control of the vehicle when braking on a slippery surface by selectively controlling the braking force of individual wheel in order to prevent the wheels from locking.



ENERGY-ABSORBING STEERING COLUMN

In the event of a head-on collision, the collapsible, energy-absorbing steering wheel and tilt/telescope steering column help to absorb some of the impact, providing better protection for the driver.



FULL AIR BRAKE SYSTEM

Full-air brake system improves braking responsiveness and performance without the need of brake fluid.



SRS AIRBAG

The SRS driver airbags are designed to complement the seatbelts to help reduce shock applied to the head & chest of the driver in the event of a frontal impact collision.

COMFORTABILITY



OPTIMIZED CAB SPACE

Better visibility and operability, spacious and quality interior provide drivers the comfort they need.



HIGH-FUNCTIONALITY SEATS

The three-dimensional, body-cradling form and seat suspension from ISRI, a top European name, provides superior seating comfort. The air lumbar support (with two-position backrest) supports the driver's back comfortably.



CAB ACCESSIBILITY

The first step is now connected directly to the chassis, bringing it closer to ground level. Cabin access is also easier and safer due to new, optimized 3-step pitch. The larger door openings and footsteps allow easy access to enter and exit.



AIR SUSPENSION

The suspension system offers improved ride comfort and stability on rough road condition.



FRONT UNDER-RUN PREVENTION (FUP)

FUP is provided at the lower front end to prevent the underrunning of a passenger car in the event of a head-on collision.



DOOR IMPACT BEAMS

High-rigidity door impact beams at the side help to increase driver and passenger safety from a side collision.



AMT GEAR

The outstanding 16 speed fully automated manual transmission (AMT) is easy and comfortable to drive, reducing driver fatigue and even improving fuel consumption under certain conditions. Driver also has the option to select a sequential manual mode for on-demand shifting conditions.



AMT MODEL

APPLICATION

BODY TYPE

A truck for every application of bodies suit your type of business.

● Drive Axle

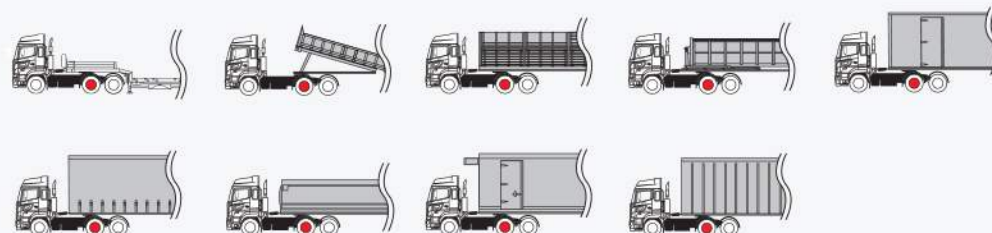

REFLECTOR HEADLAMP

Enhanced night time visibility with new large reflector headlamp.



SIDE MIRROR

Enhanced driver vision with partitioned mirror surfaces encased in a aerodynamic cover.



MANUAL TRANSMISSION

HINO's proven and highly durable manual transmission gives drivers control over gearing based on operation and road conditions faced.

MT MODEL

SPECIFICATIONS



SR1EKRGM-LAM (MT)

SR1EKRGM-MRM (AMT)

Engine	Model		HINO E13C - TM (EURO 3)	
	Type		Diesel, 6-Cylinder, Vertical-in-line, Overhead Cam, Water Cooled	
	Displacement	cc	12,913	
	Max Output (JIS Gross)	kW (PS / rpm)	309 (420) / 1,800	
	Max Torque (JIS Gross)	Nm (Kgfm / rpm)	1,903 (194) / 1,100	
	Bore & Stroke	mm	137 x 146	
	Fuel Injection System		Electronic Control, Common Rail Type	
	Max. Engine Speed	Rpm	2,150	
Clutch	Type		Dry Single Plate With Damper Springs Ø 430mm	
	Control		Hydraulic with Air Booster	
Transmission	Model		MZ12	ZF16TX2440TO
	Type		Twelve (12) Forward and Two (2) Reverse Speeds, Overdrive, Synchronesh 1st-12th	Sixteen (16) Forward and Two (2) Reverse Speeds, Overdrive
	Control		Mechanical control with power shift	Mechanical Auto
Axle	Front	Type	Reversed Elliot, "I" section beam	
		Capacity	kg	7,500
	Rear	Type	Full-Floating, Single Reduction, Single Speed by Hypoid Gearing	
		Capacity	kg	23,500
Brake	Service Brake Type		"S" Cam Type, Drum Brake, Anti Lock Braking System (ABS), Full Air, Dual Circuit	
	Parking Brake Type		Spring Brake, Acting on Front and Rear Frontward Wheels	
Suspension	Front	Type	Parabolic leaf springs with shock absorbers and stabilizers	
	Rear 1	Type	Air bag suspension with shock absorber and mechanical height control	
	Rear 2	Type	Liftable air bellow suspension	
Steering	Type		Telescopic and Tilt Steering Column with Locking Device, Recirculating Ball with Hydraulic Booster, Integral Type	
Wheels and Tires	Tire Size		295 / 80 R22.5; Eleven (11) [including One (1) Spare Tire]	
	Rim Size		Ten (10) - Stud Wheels (ISO Type); 22.5 x 8.25	
Electrical	Type		24V, Negative Earth	
	Battery		12V x 2, Series Connection; 432kC (120 A - h) at 20-hour rate	
	Alternator Capacity		24V, 60Amp	
Fuel Tank Capacity	L		390	

PERFORMANCE

G.C.W Rating		kg	66,000	
Performance	Max. Speed	km/h	90	
	Gradeability	(tan Ø) %	50.5	52
Transmission Gear Ratio	1st		10.13 / 8.05	14.68 / 12.05
	2nd		6.41 / 5.10	9.92 / 8.14
	3rd		4.04 / 3.21	6.78 / 5.56
	4th		2.51 / 1.99	4.57 / 3.75
	5th		1.59 / 1.26	3.22 / 2.64
	6th		1.00 / 0.80	2.17 / 1.78
	7th		-	1.49 / 1.22
	8th		-	1.00 / 0.82
Rear Axle Carrier	Model		SH19	
	Ratio		4.333	

DIMENSION AND MASS

Chassis Mass	Front	kg	4,750	4,685
	Rear	kg	3,215	3,205
	Total	kg	7,965	7,890
Wheelbase (WB)	mm		3,330 + 1,330	
Overall Length (OL)	mm		7,035	
Overall Width (OW)	mm		2,490	
Overall Height (OH)	mm		3,015	
Rear Overhang (ROH)	mm		995	
Front Tire Tread (FT)	mm		2,050	
Rear Tire Tread (RT)	mm		1,840	
Turning Radius (On tire)	mm		7,400	
Seating Capacity	mm		2	

HINO MOTORS SALES (MALAYSIA) SDN. BHD. is engaged in an ongoing research and development program, and reserves the right to change specification without prior notice in order to pass on to the customer any resulting advances or technical refinements. All specifications of the product are within normal manufacturing allowances and tolerances.

Dimensions are based on JPJ Body Plan Approval. It may vary +/- 50 mm from the actual body constructions.

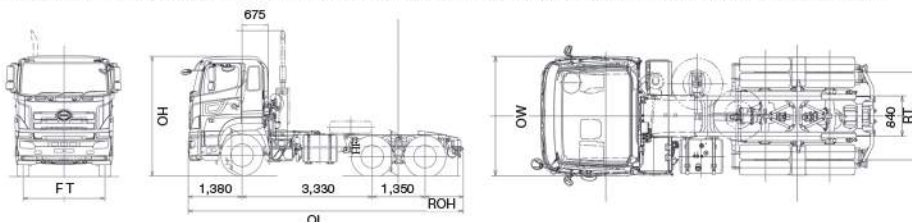

HINO Authorized Dealer: