

SPECIFICATION

MODEL	XZU600	XZU640	XZU600AT	XZC710	XZC730	XZC740	XZC710AT	XZC730AT	XZC720CREW	
FULL MODEL CODE	XZU600R - WKMLK3	XZU640R - WKMLK3	XZU600R - WKTLK3	XZC710R - WKFRL3	XZC730R - WKFRL3	XZC740R - WKFRL3	XZC710R - WKTRL3	XZC730R - WKTRL3	XZC720R - ZKFRL3	
GVW (Kg)	5,000	5,000	5,000	7,500	7,500	7,500	7,500	7,500	7,500	
DRIVE SYSTEM	CONFIGURATION	4 x 2	4 x 2	4 x 2	4 x 2	4 x 2	4 x 2	4 x 2	4 x 2	
	NO. OF WHEEL	4 Wheeler	4 Wheeler	4 Wheeler	6 Wheeler	6 Wheeler	6 Wheeler	6 Wheeler	6 Wheeler	
CAB STYLE	Standard Cab	Standard Cab	Standard Cab	Wide Cab	Wide Cab	Wide Cab	Wide Cab	Wide Cab	Crew Cab	
STANDARD WHEELBASE (mm)	2525	3075	2525	3500	4100	4400	3500	4100	3800	
ENGINE	MODEL	N04C - WG	N04C - WG	N04C - WG	N04C - WH	N04C - WH	N04C - WH	N04C - WH	N04C - WH	
	DISPLACEMENT (cc)	4,009	4,009	4,009	4,009	4,009	4,009	4,009	4,009	
	EMISSION	Euro 3	Euro 3	Euro 3	Euro 3	Euro 3	Euro 3	Euro 3	Euro 3	
	TYPE	Commonrail, Turbo Charged, Intercooled	Commonrail, Turbo Charged, Intercooled	Commonrail, Turbo Charged, Intercooled	Commonrail, Turbo Charged, Intercooled	Commonrail, Turbo Charged, Intercooled	Commonrail, Turbo Charged, Intercooled	Commonrail, Turbo Charged, Intercooled	Commonrail, Turbo Charged, Intercooled	Commonrail, Turbo Charged, Intercooled
	MAX OUTPUT (PS)	104 (141) / 2,500	104 (141) / 2,500	104 (141) / 2,500	115 (156) / 2,800	115 (156) / 2,800	115 (156) / 2,800	115 (156) / 2,800	115 (156) / 2,800	115 (156) / 2,800
MAX TORQUE (Nm)	402 (41) / 1,600	402 (41) / 1,600	402 (41) / 1,600	430 (44) / 1,400	430 (44) / 1,400	430 (44) / 1,400	430 (44) / 1,400	430 (44) / 1,400	430 (44) / 1,400	
TRANSMISSION / MODEL	Manual 5-Speed / RE50	Manual 5-Speed / RE50	Automatic 6-Speed / A860E	Manual 6-Speed / RE61	Manual 6-Speed / RE61	Manual 6-Speed / RE61	Automatic 6-Speed / A860E	Automatic 6-Speed / A860E	Manual 6-Speed / RE61	
SERVICE BRAKES	Vacuum Servo Hydraulic	Vacuum Servo Hydraulic	Vacuum Servo Hydraulic	Vacuum Servo Hydraulic	Vacuum Servo Hydraulic	Vacuum Servo Hydraulic	Vacuum Servo Hydraulic	Vacuum Servo Hydraulic	Vacuum Servo Hydraulic	
REAR AXLE MODEL	BD26A	BD26A	BD26A	SH12-1	SH12-1	SH12-1	SH12-1	SH12-1	SH12-1	

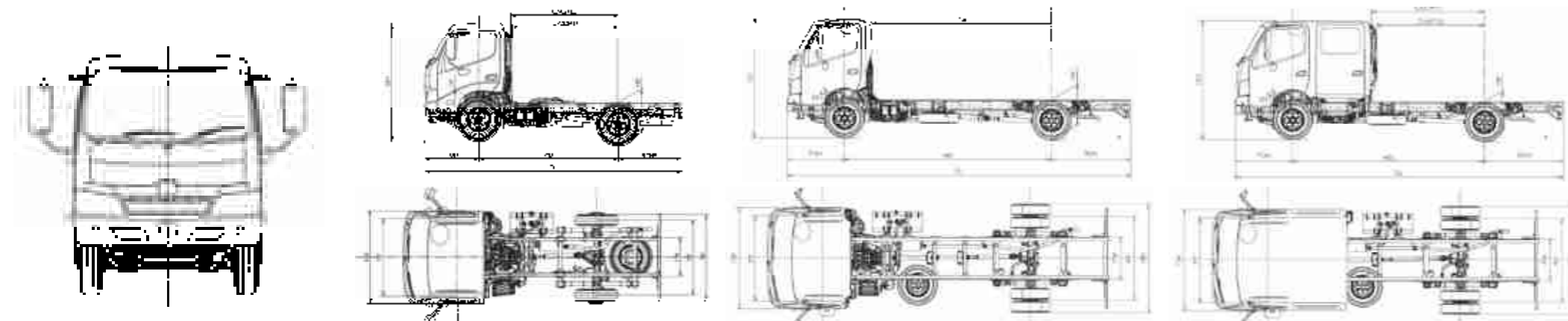

HINO 300

Series **PRO**

Strong, Spacious, Safety, Smart
Built for Ultimate Customer Success



HINO MOTORS SALES (MALAYSIA) SDN BHD (187863-U)

Selangor: Lot PT 24, Jalan 223, Section 51A, 46100 Petaling Jaya, Selangor Darul Ehsan, Malaysia. Tel: (603) 7957 5199 (12 lines) Fax: (603) 7954 3276
 Sarawak: Lot 1076, Block 218, 4th Mile, Penrissen Road, 93250 Kuching, Sarawak, Malaysia. Tel: (082) 451 611 (5 lines) Fax: (082) 451 993
 Sabah: Miles 4 1/2 Jalan Tuaran, Lot No. 353, Taman Cempaka, Likas, 88450 Kota Kinabalu, Sabah, Malaysia. Tel: (088) 393 663 Fax: (088) 424 223

www.hino.com.my

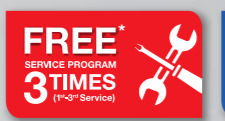

HINO Authorized Dealer:

Terms and Conditions apply*

STRONG

▼ HORSEPOWER & TORQUE

High horsepower and torque engines that offers powerful drive for all application and road condition



EURO 3 ENGINE



4 WHEELER

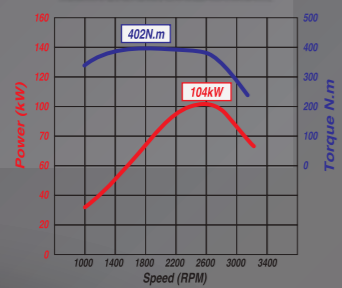

MAX OUTPUT (PS / rpm)

141 PS / 2,500 rpm

MAX TORQUE (Nm/rpm)

402 N.m / 1,600 rpm

6 WHEELER

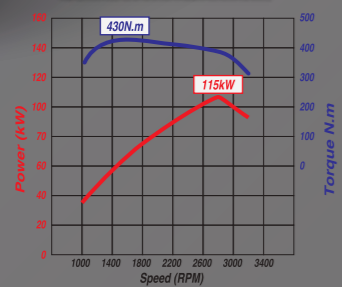

MAX OUTPUT (PS / rpm)

156 PS / 2,800 rpm

MAX TORQUE (Nm/rpm)

430 N.m / 1,400 rpm

▼ TRANSMISSION

Comes with manual and fully automatic transmission that best-fit to customer business field



MANUAL TRANSMISSION ▶

4-wheeler comes with 5-speed manual transmission, 6-wheeler with 6-speed manual transmission for smooth acceleration from stationary position



◀ 6-SPEED AUTOMATIC TRANSMISSION

This system is designed for smooth automatic gear changes and superior fuel efficiency that gives easier and comfortable driving

SPACIOUS

4 WHEELER



▲ GVW UP TO 5 TONNE

The highest Gross Vehicle Weight (GVW) in its category up to 5 tonne (5,000 kg)

6 WHEELER



▲ BIGGEST BODY IN ITS CLASS

Widest rear tread in its category that is convenient to fit two wooden pallets side by side

SAFETY

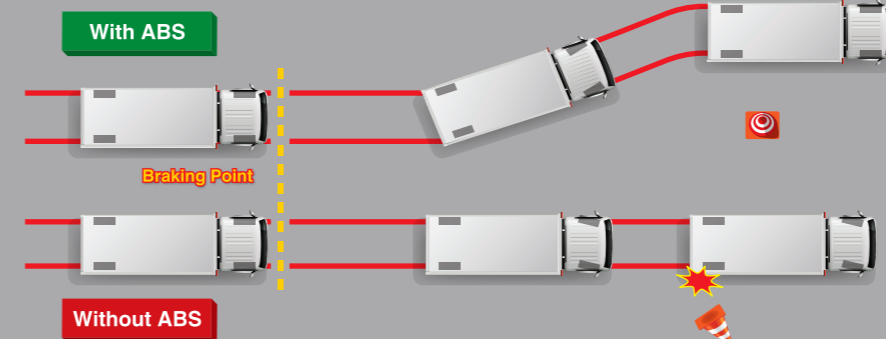

▲ ANTILOCK BRAKING SYSTEM (ABS)

An active safety feature designed to help driver retain steering control by preventing wheels from locking up during emergency braking

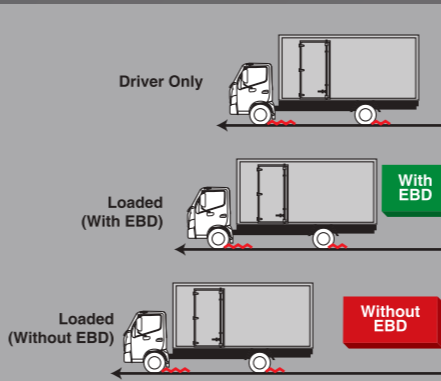

▲ ELECTRONIC BRAKEFORCE DISTRIBUTION (EBD)

Optimizes brake force depending on the load to ensure optimal braking system

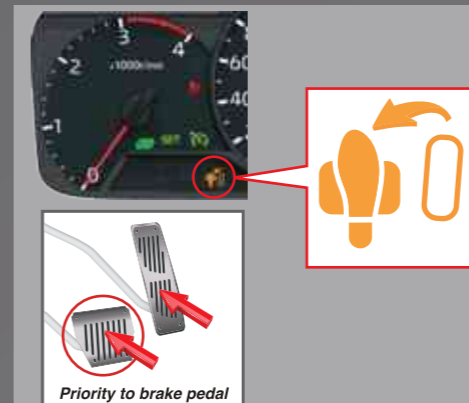

▲ BRAKE OVERRIDE SYSTEM (BOS)

As a failsafe measure when acceleration and brake pedal are being pressed at the same time, priority will be given to braking



◀ THEFT MONITORING & SOS CALL

Monitor against break-in scenarios for your vehicle with 24-hour call center support and provide highly accurate location information that improves asset visibility

Note : Measurement various from body

SMART



Security & data tracking system that provides:

- Fuel consumption data
- Fuel economy guide
- GPS for tracking/ tracing vehicle location
- Driving Behaviour

▲ HINO CONNECT SYSTEM

Supports logistics operation in improving operational efficiency in terms of increase of profit, improve safety and security, encourage good driving behaviour, reduce unplanned downtime, and monitor truck maintenance by understanding the key elements of vehicle

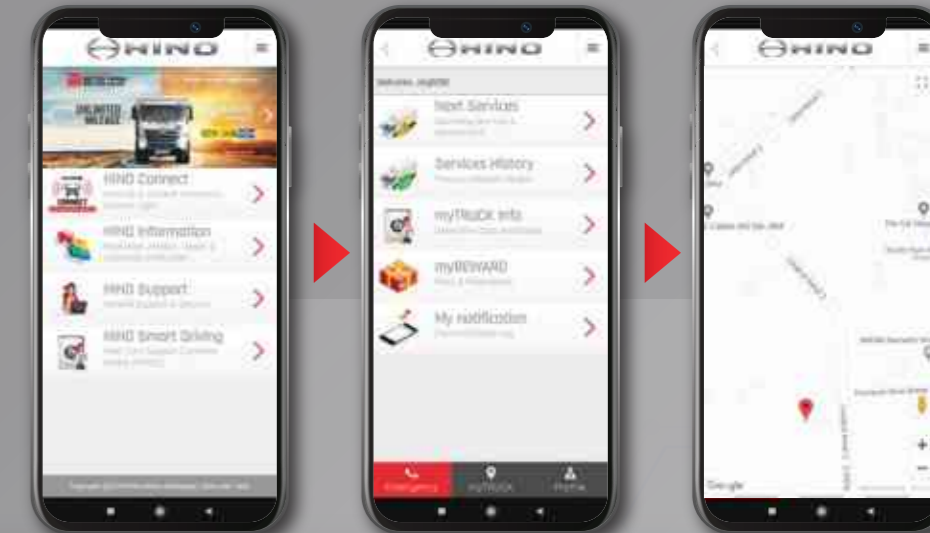

▲ myHINO MOBILE APP

A specialized mobile application designed to link with HINO CONNECT System that allows user to track and monitor their vehicle in operation at one's fingertips

Note : Some images may be used for illustration purposes only.

SPECIFICATION

		MODEL	XZU600	XZU640
ITEM	MODEL CODE		XZU600R - WKMLK3	XZU640R - WKMLK3
ENGINE	MODEL		N04C-WG	
	TYPE		Diesel, 4-cylinder Vertical In-line, Overhead Valve, Water Cooled	
	DISPLACEMENT	cc	4,009	
	MAX OUTPUT (JIS GROSS)	kW(PS)/rpm	104 (141) / 2,500	
	MAX. TORQUE (JIS GROSS)	Nm(kgfm)/rpm	402 (41) / 1,600	
	BORE & STROKE	mm	104 x 118	
	FUEL INJECTION SYSTEM		Electronic Control Commonrail Type	
	AIR INTAKE SYSTEM		Turbo Charged Intercooled, Stack Type	
	MAX.ENGINE SPEED	rpm	3,100	
CLUTCH	TYPE		Dry Single Plate, Diaphragm Type with Damper Spring	
	DIAMETER	mm	300	
TRANSMISSION	MODEL/NO. OF SPEED		RE50 / Manual 5-Speed	
	TYPE		Five (5) Forward and One (1) Reversed, with Overdrive	
	RATIO (1st - Top)		5.342 / 0.712	
AXLE	FRONT	Type	Reversed Elliot, "I" Section Beam	
		Capacity	kg	2,600
	REAR	Type	Full Floating, Single Reduction, Single Speed by Hypoid Gearing	
		Capacity	kg	4,400
BRAKE	SERVICE BRAKE TYPE		Hydraulic System with Ventilated Disc for Front Wheels and Dual Two (2) Leading Shoes For Rear Wheels	
	SERVICE BRAKE CONTROL		Vacuum servo hydraulic, dual circuits and Anti-lock Braking System (ABS)	
	PARKING BRAKE TYPE		Mechanical, Internal Expanding, Acting on Transmission Output Shaft	
	EXHAUST BRAKE TYPE		Electric -Vacuum Actuator with Valve in Exhaust Pipe	
SUSPENSION	FRONT	Type	Semi Elliptic Leaf Spring with Dual Acting Shock Absorber and Stabilizer	
	REAR	Type	Semi Elliptic Main and Leaf Spring with Dual Acting Shock Absorber	
FRAME	FRAME WIDTH	mm	700	
	Height x Width x Thickness	mm	177 x 60 x 4.5	
CABIN	TILTING		Mechanical Type	
	STEERING		Telescopic & Tilt Steering Column with Locking Device, Recirculating Ball with Hydraulic Booster, Integral Type	
	POWER WINDOW		Equipped	
	CENTRAL LOCKING		Equipped	
	SEAT BELT		Equipped	
WHEELS & TIRES	WHEEL TYPE		5 Stud Disc Wheel	
	WHEEL SIZE		16 x 5.50F	
	TIRE SIZE		205/85R16 - 12PR	
ELECTRICAL	TYPE		24V, Negative Earth	
	BATTERIES		12V x 2 , Series Connection	
	ALTERNATOR CAPACITY		24V - 60 Amps	
FUEL TANK CAPACITY	L		80	100
PERFORMANCE				
G.V.W RATING	kg		5,000	
PERFORMANCE	Max Speed	km/h	100 (Speed Limiter)	
	Gradeability	(tan Ø) %	55.3	
TRANSMISSION RATIO	MODEL		RE50	
	1st		5.342	
	2nd		2.975	
	3rd		1.604	
	4th		1.000	
	5th		0.712	
	Reverse		4.970	
REAR AXLE	Model		BD26A	
	Ratio		4.625	
DIMENSION & MASS				
CHASSIS MASS (with std tools set, Fuel Full Tank & spare tire)	FRONT AXLE	kg	1,400	1,445
	REAR AXLE	kg	660	675
	TOTAL	kg	2,060	2,120
DIMENSION	WHEELBASE	WB mm	2,525	3,075
	OVERALL LENGTH	OL mm	4,680	5,440
	OVERALL WIDTH	OW mm		1,695
	OVERALL HEIGHT	OH mm		2,130
	CAB TO AXLE CENTER	CA mm	1,945	2,495
	FRONT OVERHANG	FOH mm		985
	REAR OVERHANG	ROH mm	1,135	1,370
	FRONT TREAD	FT mm		1,400
	REAR TREAD	RT mm		1,350
	TURNING RADIUS (on tire)	mm	5,500	6,600
SEATING CAPACITY			3	



HINO MOTORS SALES (MALAYSIA) SDN BHD (187863-U)

Selangor: Lot PT 24, Jalan 223, Section 51A, 46100 Petaling Jaya Selangor Darul Ehsan, Malaysia Tel: (603) 7957 5199 (12 lines) Fax: (603) 7254 3276
 Sarawak: No. 230 Lot 3477, Block 226, KKND (P/L 2534), Jalan Kung Phun 93250 Kuching, Sarawak, Malaysia Tel: (082) 451 611 (5 lines) Fax: (082) 451 993
 Sabah: Lot No. 353, Taman Cempaka, Likas, 88450 Kota Kinabalu Sabah, Malaysia Tel: (088) 393 663 Fax: (088) 424 223